

S. Carolina

(47)

Pursuant to a warrant from John Thomas Esq. Com. of Loc. N. Saluda River. I have admeasured and laid out unto John McLintock a tract of One hundred acres of land on the Branches of Warricks Creek in Laurens County Bounded by lines Running S. 45° E. on Isaac McLintock's Land N. on Wm. Corvick's Land S. on vacant & John Simpson's Land N.W. on Marshall Franks and John M. Dorell's land, and hath such Shape and Marks as the above plat Represents.

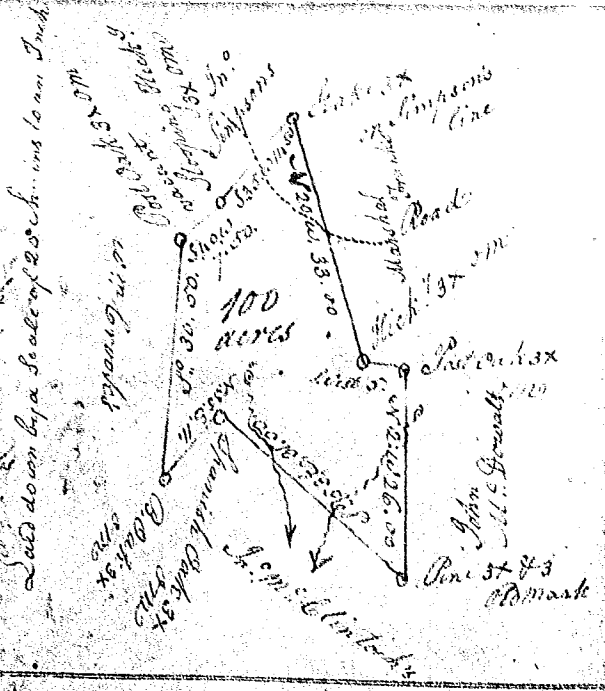

Surveyed the 17<sup>th</sup> March 1792  
Robert Hanna D.S.

S. Carolina

Pursuant to a warrant from John Thomas Esq. Com. of Locations N. Saluda. Dated the 17<sup>th</sup> day of March 1792. I have admeasured and laid out unto Alexander Mills a tract of forty acres of Land on the head of Duncan's Creek, and including the head of a small branch of Warricks Creek in Laurens County Bounded by a line Running N 40° W on Robert Boyd's land by a line Running S. on William Chick's and Sarah Venis's land and by a line Running N 80° E on Mark Goodwin's land, and hath such Shape and Marks as the above plat Represents.



Surveyed the 17<sup>th</sup> March 1792

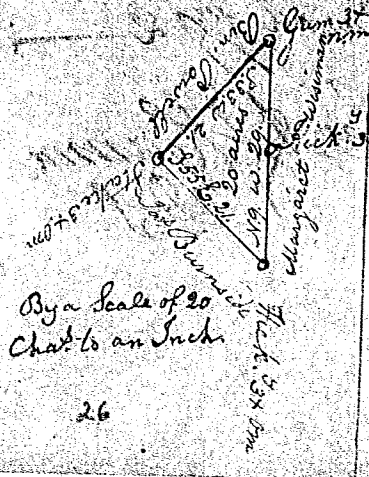

By a Scale of 20 Chas to an Inch

South Carolina  
Laurens County  
Pursuant to a warrant from John Thomas Esq. Com. of Locations N. Saluda River dated the 17<sup>th</sup> day of April 1792 - I have admeasured and laid out unto Tyrie Glen twenty acres partly on Norths Creek the Water of Little River & Bounded East on Margaret Wiseman W. on James Burnside N.W. on Benjamin Powell and hath such Shape form and Marks as the above plat Represents.  
Surveyed the 18<sup>th</sup> day of April 1792  
John Rodgers D.S.